



1300 Sumner Avenue  
Cleveland, Ohio 44115-2851  
Phone: 216-241-7333 • Fax: 216-241-0105  
E-mail: [dasma@dasma.com](mailto:dasma@dasma.com)

## Water Infiltration Under the Bottom of a Sectional Door

### Introduction

It is a common occurrence with exterior facing sectional doors for rainwater to migrate past the bottom edge to the interior of the space. This can cause unwanted and unnecessary accumulation in the interior of a structure and can even cause water damage if not addressed properly during construction. This Technical Data Sheet provides suggestions to help prevent this problem from occurring.

### Scope

This Technical Data Sheet does not include water infiltration at the jambs or header, and does not include driven or pressurized water directed at or between the section interfaces.

### Door Solution

A common practice used to prevent floor level water infiltration is a slightly inclined lip or sill (Figure 1) that the door rests upon. Alternately, a rectangular notch in the lip of the slab into which the door can rest and located below the slab grade (Figure 2) improves the door seal and greatly aids in disallowing water infiltration from the exterior environment to the interior. The rectangular notch should accommodate up to 2" wide garage door track and up to a 2" thick garage door section, to allow the door to fully close.

---

**Note: Technical Data Sheets are information tools only and should not be used as substitutes for instructions from individual manufacturers. Always consult with individual manufacturers for specific recommendations for their products and check the applicable local regulations.**

This Technical Data Sheet was prepared by the members of DASMA's Commercial & Residential Garage Door Division Technical Committee. DASMA is a trade association comprising manufacturers of rolling doors, fire doors, grilles, counter shutters, sheet doors, and related products; upward-acting residential and commercial garage doors; operating devices for garage doors and gates, sensing devices, and electronic remote controls for garage doors and gate operators; as well as companies that manufacture or supply either raw materials or significant components used in the manufacture and installation of the Active Members' products.

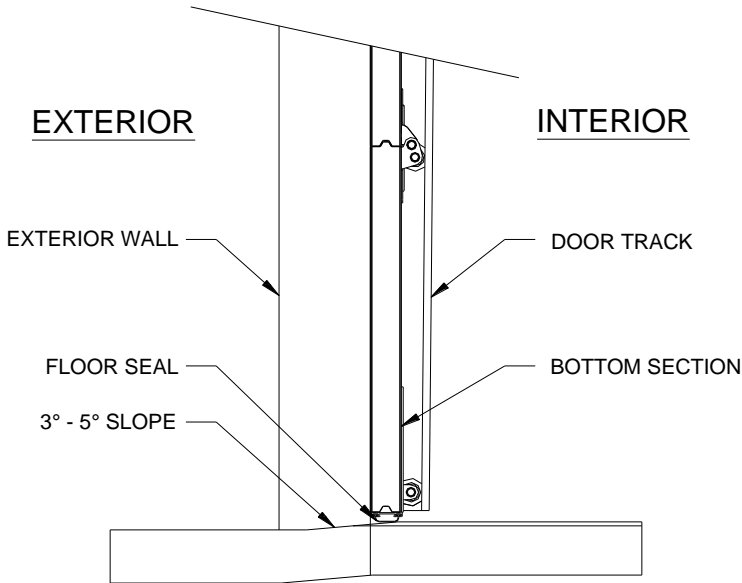

**Figure 1**  
**Sloped Slab – Section View**

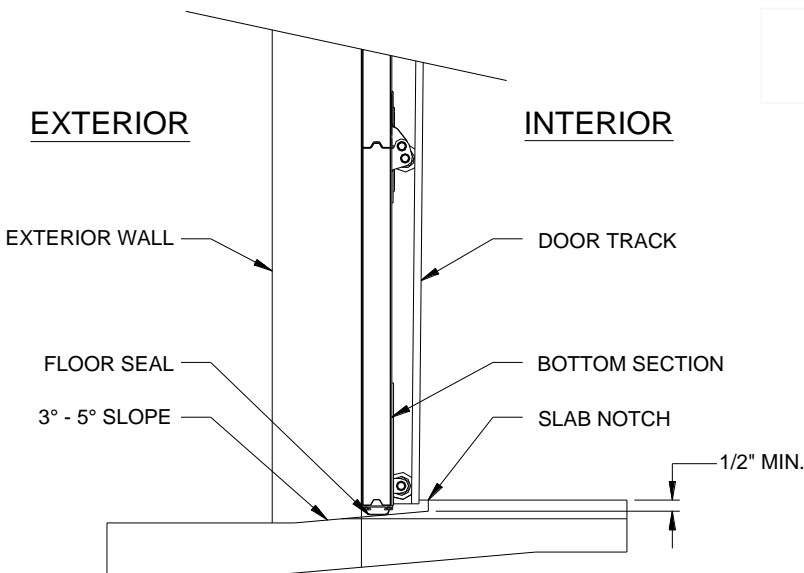

**Figure 2**  
**Notched Slab – Section View**

**Note: Technical Data Sheets are information tools only and should not be used as substitutes for instructions from individual manufacturers. Always consult with individual manufacturers for specific recommendations for their products and check the applicable local regulations.**

This Technical Data Sheet was prepared by the members of DASMA's Commercial & Residential Garage Door Division Technical Committee. DASMA is a trade association comprising manufacturers of rolling doors, fire doors, grilles, counter shutters, sheet doors, and related products; upward-acting residential and commercial garage doors; operating devices for garage doors and gates, sensing devices, and electronic remote controls for garage doors and gate operators; as well as companies that manufacture or supply either raw materials or significant components used in the manufacture and installation of the Active Members' products.